

INSTRUCTIONS FOR USE SAFRANBOLU

İÇİNDEKİLER

1. Foreword	3
2. Safe and beneficial usage	4
3. Introduction	5
4. Warning and introduction labels	6
5. Norms and certificates	7
6. Settlement and environmental conditions	8
7. Cleaning, maintenance and technical service	9
8. Power connection	12
9. Recycling	13
10. Loading	13
11. Frames and covers	14-22
12. Technical details	14

1. Foreword

Dear valued customer,

Before using your device, read the instruction of use carefully. The instruction of use includes important information about setup, safety, usage and care of your device. Thus you both protect yourself and prevent any damage to your device. Keep your instructions of use and hand in to the next owner.

Products do not contain PCB, PCT, asbestos, formaldehyde, cadmium, similar hazardous substances and substances that harm to the user. Producing company does not take any responsibility for any damage that may occur in cases such as misuse of the device, installation faults, lack of periodic care, not using genuine parts, failure to comply with the given information, warnings and precautions.

2. Safe and beneficial usage

Some statements and practices in this instruction of use can change depending on the type and the model of the device.



THIS DEVICE IS MANUFACTURED ACCORDING TO THE LEGAL SAFETY REGULATIONS.

Attention should be paid to following rules below for a non-hazardous and a safe use.

- Before connecting the device to the electric wiring, compare the type tag data(voltage and frequency) to your data in the electric network. In order not to damage your device, these data have to match each other. When in doubt, call your electrician.
- The safety of your device can only be provided if a protected wiring system (ground cable) that is laid according to the rules is connected. It is very important to follow this basic safety measure. When in doubt, have the electrical wiring examine by a specialist. Otherwise, the producing company is not responsible for any damage that may occur. (e.g., electrical shock)
- Montage, connection and repair works of the device must only be done by qualified personnel. Otherwise, the producing company cannot be held responsible for any possible dangers for the user.
- Do not use any splicing cables in the electrical connection of the device. Splicing cables cannot provide the necessary safety for your device.
- Do not keep explosive substance or substances that contain inflammable gases (e.g., spray boxes) in your device. May cause mixtures to explode.
- Do not operate electrical tools inside the device. There may be a sparkle. Risk of explosion!
- Do not use steam pressure cleaning tools while cleaning the device. Pressurized steam can leak to the electrolyte parts and can cause a short circuit.
- If you have any doubt about electrical connection, work or safety of the device, appeal for help.
- Do not remove any external protection cover unless specifically stated in this instruction of use. Otherwise, you can reach the life-threatening electrical parts.
- All work on electrical parts should be done by an authorized and qualified electrician or a person.
- Maximum load line must be taken into account when loading the goods into the device.
- Protective equipment should be used during cleaning and service of the device. (e.g.,gloves)
- Do not allow children to play with the device.
- The device should not be used by people with physical (visual, audio) or mentally disabled, children and persons with lack of experience and knowledge, without the supervision of a person who responsible for their safety. Children should be supervised while using the device and make sure they do not play with the device.

3. Introduction

Bu This guide has been prepared for Safranbolu device. As a whole, there are information about how to use the device, technical specifications, installment and montage, of the device, information and suggestions for the users and cleaning and care operations.

Safranbolu is a vertical, with or without a cover, multi-shelf designed cooler. The cooling unit is located on the device and the cooling unit is a plug-in device. With its wide display area and loading capacity, it is suitable for normal to and larger stores. Food such as dairy & meat, products can be displayed in the cabinet. The cabinet has an off cycle defrost. Run case module is 1250mm, 1875mm, 2500mm long.

4. Warning and introduction labels that on the device

The labels on the device and what they about are written below. However, the labels can change according to the type and version of the device.

- Product's identification label (Image 1): Product's identification label is located in the cabin and includes device's technical data as follows: Producing company, logo and address information, certificate that belongs to the product and certificates of quality that belong to the producer, version of the device, serial number of the device, production date of the device, climate class, temperature range, the type of refrigerant used in the device, approved certificate of the device and directives that are suitable, test pressure, working pressure, working voltage values, the power of evaporator fan, lighting electric power, night curtain electric power, defrost resistors electric power, frame resistances electric power, glass resistances electric power, etc.
- High voltage label (Image 2): The high voltage label is located on the conduit box of the device.
- Transport label (Image 3): Pallets are attached to the cabinets for transportation. Transport by forklift or pallet can be done thanks to this pallet. There is a label on the device about the transport location. Transport: The aforementioned label should be placed in the middle of the forklift arms.
- Fragile Label (Image 4): This label is located on the product and points out that there is a risk of fracture. At this point, it should be treated lightly to prevent any damage that may occur.
- Non-Print Label (Image 5): It is located on the base of the device, on the pan.
- Pressure Label (Image 6): The pressure label is located at the exit point of the copper pipes. It is used in order to determine the amount of nitrogen.

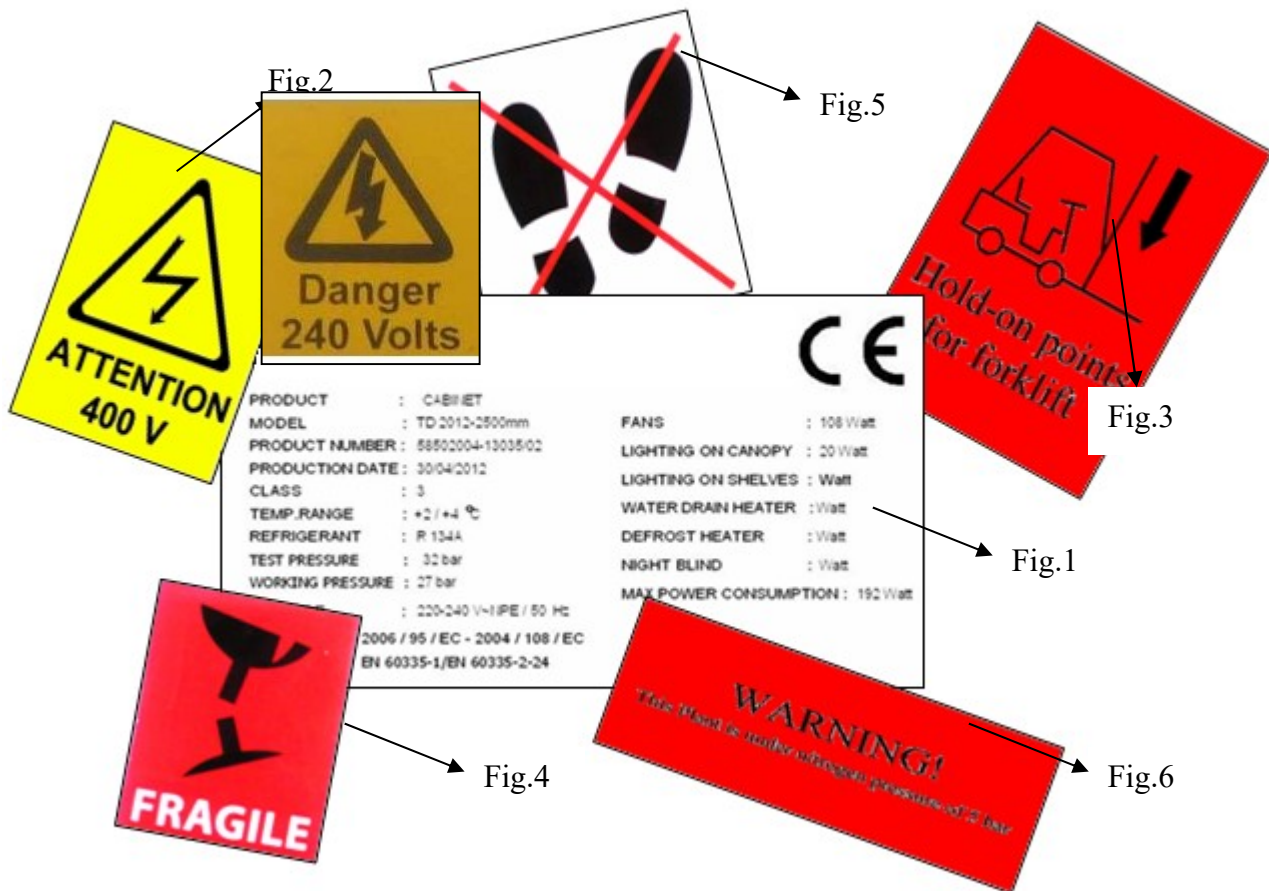

5. Norms and Certificates

Referans Norms that used as reference and approved certificates of the device:
EN 60204-1; EN 60439-1; EN 60439-2

ENVIRONMENTAL CLIMATIC MEDIA (EN 23953)

This device has been tested for a climatic media 3.

Climatic Media	Dry Air Temperature	Relative Humidity	Dew Point
1	16°C	80%	12°C
2	22°C	65%	15°C
3	25°C	60%	17°C
4	30°C	55%	20°C
5	40°C	40%	24°C
6	27°C	70%	21°C

Directives that are suitable for the device EEC 73/23, EEC 98/37

6. Settlement and environmental conditions

Attention should be paid for placement listed below:

- Do not place your device in direct sunlight.
- Do not place your device in front of a door.
- Do not place your device close to any heat source.
- Do not place your device where it will be exposed to direct air flow such as a air conditioning or a ventilator.
- Do not place your device in open air.
- Do not place your device near the places with explosive gas.

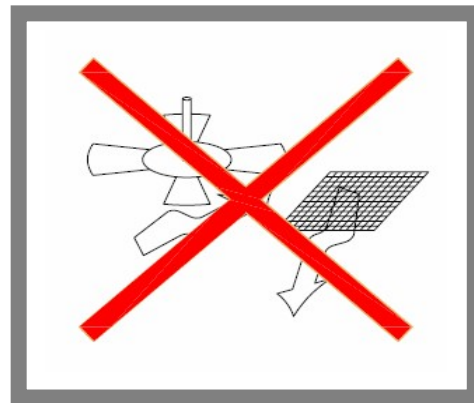
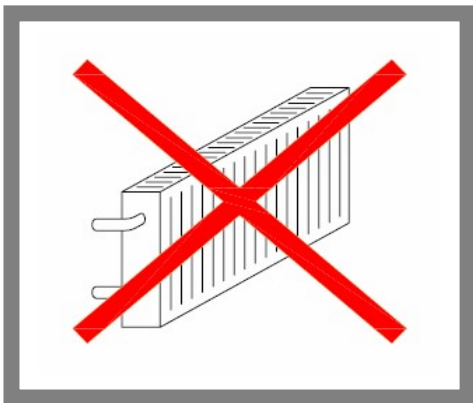
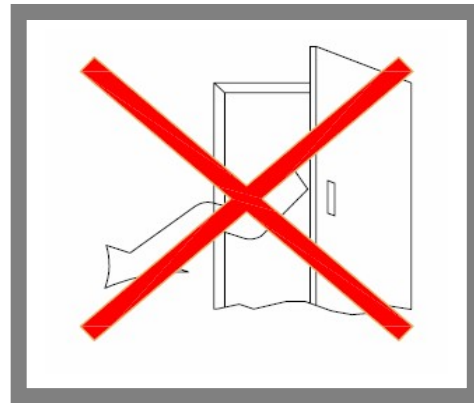
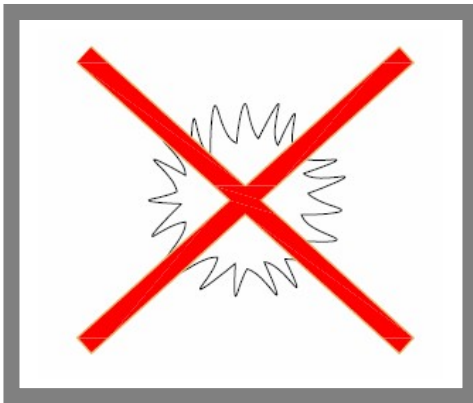

7. Cleaning, Maintenance and Technical Service



MAKE SURE THE CABIN'S MAIN SWITCH IS OFF OR NOT ELECTRICALLY CONNECTED BEFORE ANY CARE AND CLEANING OPERATION

Make sure that the package isn't damaged when it is purchased. Open the package without harming the device. Make sure that any parts of the device are undamaged and in place. Contact the supplier company in case of any damage.

It is essential to clean and maintain your device periodically. The cleaning part of these is done by the user. These are cleaning the interior and exterior surfaces of the device. Before starting to clean your device, turn off the cooling and lighting switch, disconnect the electricity. Take the goods in the device and put them in a place that will not go off during cleaning.



AS A CLEANING MATERIAL, DO NOT USE ABRASIVE AND SCRATCHING SUBSTANCES, ALCOHOL, SODA OR CHEMICAL SOLVENTS!

A. External cleaning (Daily / Weekly)

- Clean the exterior parts of the cupboard weekly with detergent and warm water.
- Do the cleaning with a soft cloth and clean water.
- Do not use abrasives, rubber cloth or solvents that will damage the exterior surface.
- Do not use water or detergent on electrical parts.
- Do not use alcohol to clean plexiglass parts.

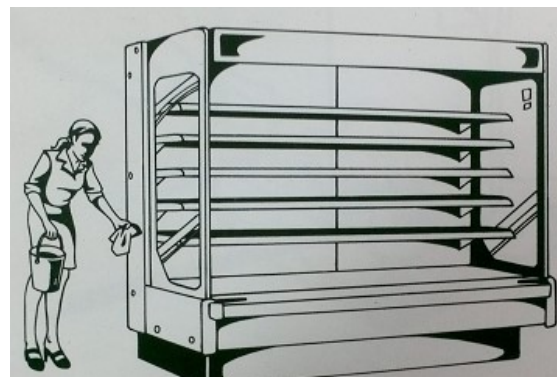

B. Internal cleaning (Monthly)

- Before the internal cleaning, wait for the interior surface of your device to react to ambient temperature.
- Remove all the parts that can be removed (e.g., pan, shelves, different wires, etc.), clean them with hygienic cleaners mixed with warm water and dry the parts carefully.
- While cleaning the pans, be careful not to let foreign substances and dirt fall into the parts where the fans are.
- Wipe the dirt in the evaporator section with a moist cloth after cleaning residual liquids and residues from the products.
- Disinfect the inside of the device so that the malodors caused by rotting and deterioration do not affect the products. When disinfecting, do not use substances that smell strongly and may cause acidification.
- If the water drain is not completely blocked, wash it with plenty of water without removing it. Repeat this process until you are sure that the water drain is cleaned.
- Contact the authorized service in abnormal situations that seen on the device during or after cleaning

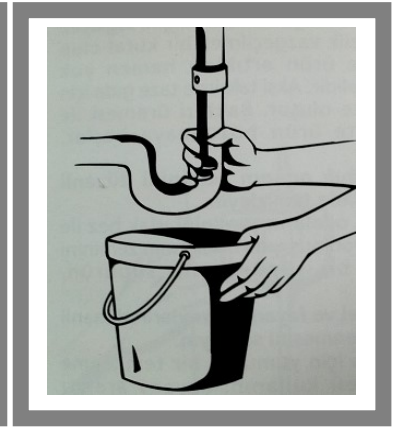
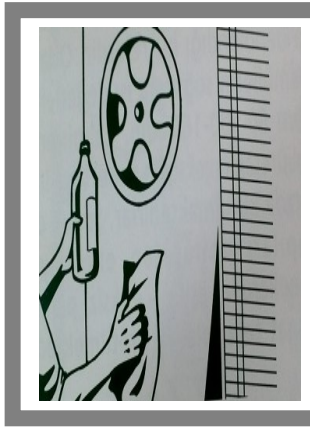
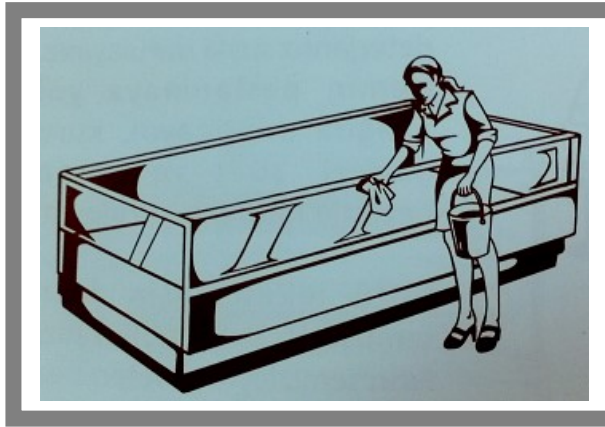

DO NOT USE STEAM PRESSURE CLEANING TOOL. STEAM CAN SPREAD TO THE ELECTROLYTE PARTS OF THE DEVICE AND CAUSE



DO NOT USE HOT WATER ON COLD GLASS SURFACES. IT MAY CAUSE THE SHATTERING GLASS AND INJURY!

After cleaning, put the goods back into your device and make sure that the fans, ceiling lights, electrical cables and all other electrical equipment are dry. Turn on the lighting and cooling switch.

C. Technical service

- Make sure that the ambient temperature and humidity are not apart from the values that are shown. Hence, make sure that the air conditioning, and heating devices are working in the store accurately.
- Make sure that the products do not contact to the direct sunlight.
- Isolate the glass of the market against sunlight.
- Do not point the spotlights directly on the device.
- Do not block the suction grilles in a way that prevents air intake.
- Use the device only for the storage of refrigerated products.
- Make sure the device cools down constantly. Check the fridge twice a day.
- Load the device in accordance with the loading line, do not exceed the upper limit.
- When the device fails, empty the products from the device immediately.
- When the screw falls out and the lamp lights up, replace it immediately.
- Check the automatic defrost periodically.
- Make sure there are no abnormal water condensations. If it comes to that, call the cooling technician immediately.
- Carry out periodic maintenance continuously.

Devices can break down despite all the cleaning and care. When you notice that the device doesn't work, go by instructions below:

- Is the cooling switch open?
- Is everything normal in the fuse box of the radiator assemblies?
- Is there energy?

If the above-mentioned questions' answers are YES, there is a problem with the radiator assemblies or installment. Let the technical service know immediately. Put your goods in your device into another place that will prevent them from deteriorating until the technical service arrives.

IN CASE OF GAS LEAK AND BURNING: Do not stand in the room if there is no air flow. Unplug the cooler. **DO NOT USE WATER TO EXTINGUISH FIRE. ONLY USE A FIRE EXTINGUISHER.**



IN CASE OF GAS LEAK AND BURNING: DO NOT STAND IN THE ROOM IF THERE IS NO AIR FLOW. UNPLUG THE COOLER. DO NOT USE WATER TO EXTINGUISH FIRE. ONLY USE A FIRE

8. Power connection



CHECK THE ELECTRICAL DIAGRAM ON THE PILOT BOX BEFORE MAKING THE ELECTRICAL CONNECTIONS AND MAKE THE CONNECTIONS ACCORDING TO THIS DIAGRAM!

When making the electrical connections, the following details should be examined.

- Automatic switch and main switch that protected against electric currents must be used in the device. The user must know the location of the easily accessible switch in case of emergency.
- The safety of your device can only be provided if a protected wiring system (ground cable) that is laid according to the rules is connected. It is very important to follow this basic safety measure. When in doubt, have the electrical wiring examine by a specialist.
- Maximum voltage change should be $\pm 6\%$.
- The thickness of the cable in the energy line should be at least 2.5 mm^2 and it should be able to handle high current.
- The energy line cable should not be longer than 4-5m, if the cable length increases depending on the situation, the cable section should be increased.
- Do not use extension cable in the electrical connection of the device.
- Make sure that the temperature and humidity are in accordance with the reading in EN23953 and that the climate class is 3 (+ 25 ° C; R.H. 60%) for the cooler to work properly.
- All work related to the electrical connection of the device and other electrical parts should be made by an authorized and qualified person with an electrical certificate.

9. Recycling

Each country separates the cabinet's parts according to waste disposal and environmental laws. Hence, each country provides recycling. The parts used in our products generally:

Painted sheet metals: Stiles, shelves, shelf handles, back panel, pans.

Copper-Aluminum: Condenser, evaporator, electrical parts.

Galvanized sheet metals: Bottom panels, painted panels, basic parts, pan.

Polyurethane: Thermal injection.

Thermopane: Glass pieces.

PVC: Handles

Polystyrene: Thermoform side walls.

Polycarbonate: Lighting cover.

10. Dolaba Mal Yükleme

There are important information about the loading below:

- Place your products on the shelves neatly.
- Do not exceed the loading capacity on pans and shelves. (160 kg / m²)
- In the devices with shelves, the shelves can be used at different angles depending on the device type. (0 °, 10 °, 20 °)
- Do not leave space between products loaded on the same shelf in the devices with shelves.
- Leave a minimum of 30mm space for air circulation between the upper shelf and the product in the devices with shelves.
- Do the loading process in accordance with the product consumption rate.
- Do not load products anywhere other than shelves and pans.
- Do not load products that are not allowed to cool down on your device.
- Do not load in a way that prevents the cold air flow. (e.g., front suction zone)

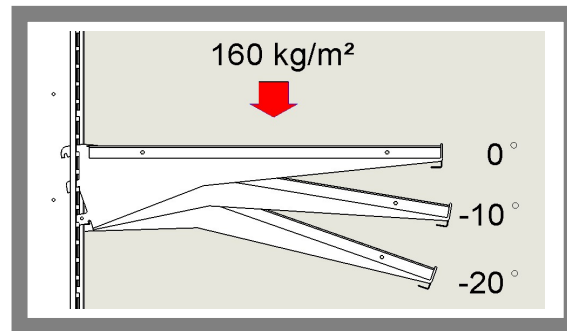

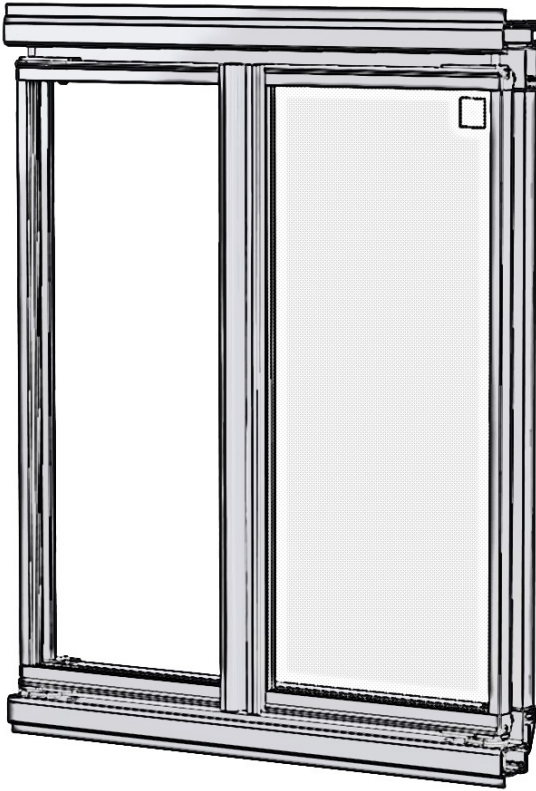

MONTAGE and INSTRUCTION OF USE (Envifit Slim Hinge Door-Gravity)

Required tools

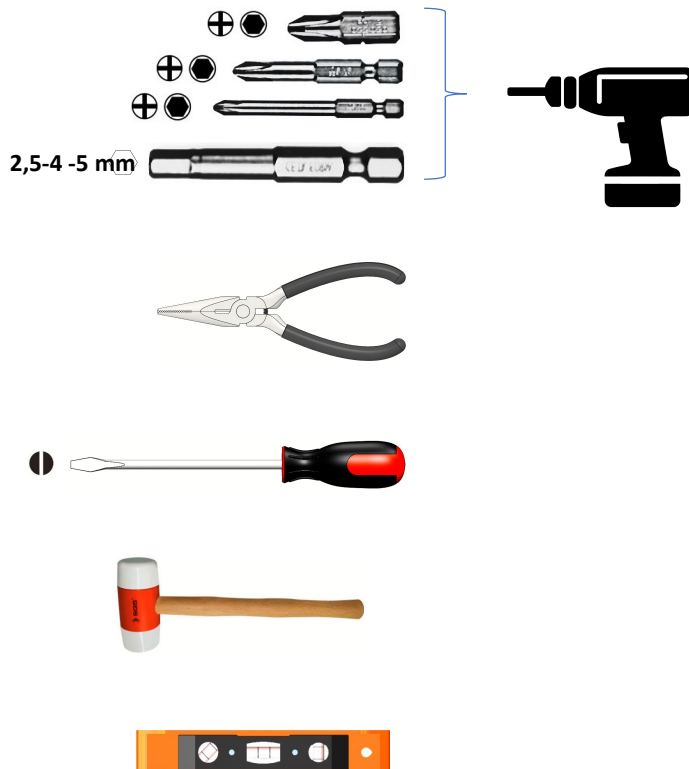

Adjusting the miter of the cabinet

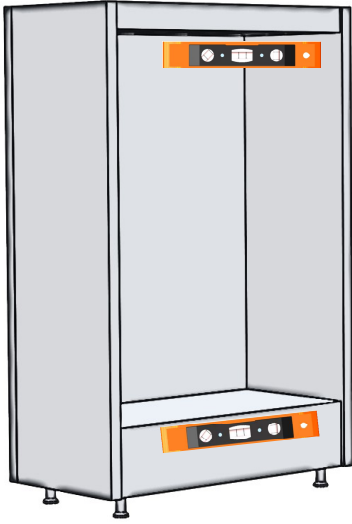

The upper and lower parts of the cabinet must be miter! If not, adjust the cooler legs.

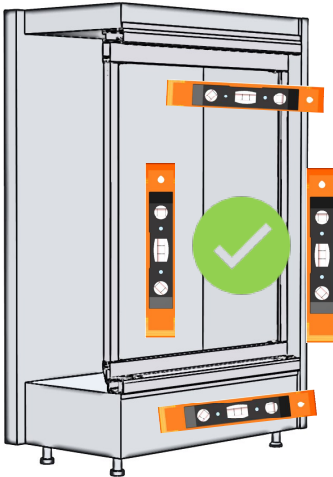

Assemble the cover frame by mitering it with the help of the water gage in the image.

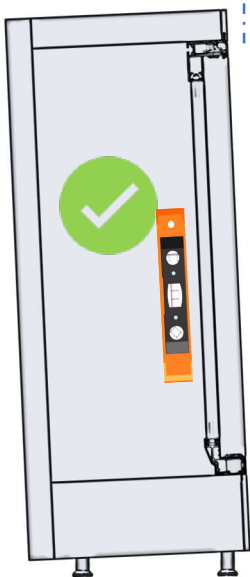

After loading, the doors and the shelves of the cabinet can lean forward because the surface conditions are not smooth. And this situation leads to the doors' incapability to close by themselves! Hence, the cabinet legs should be placed in the backswept position that shown in the image! So, it will create a natural moment that will help the doors close.

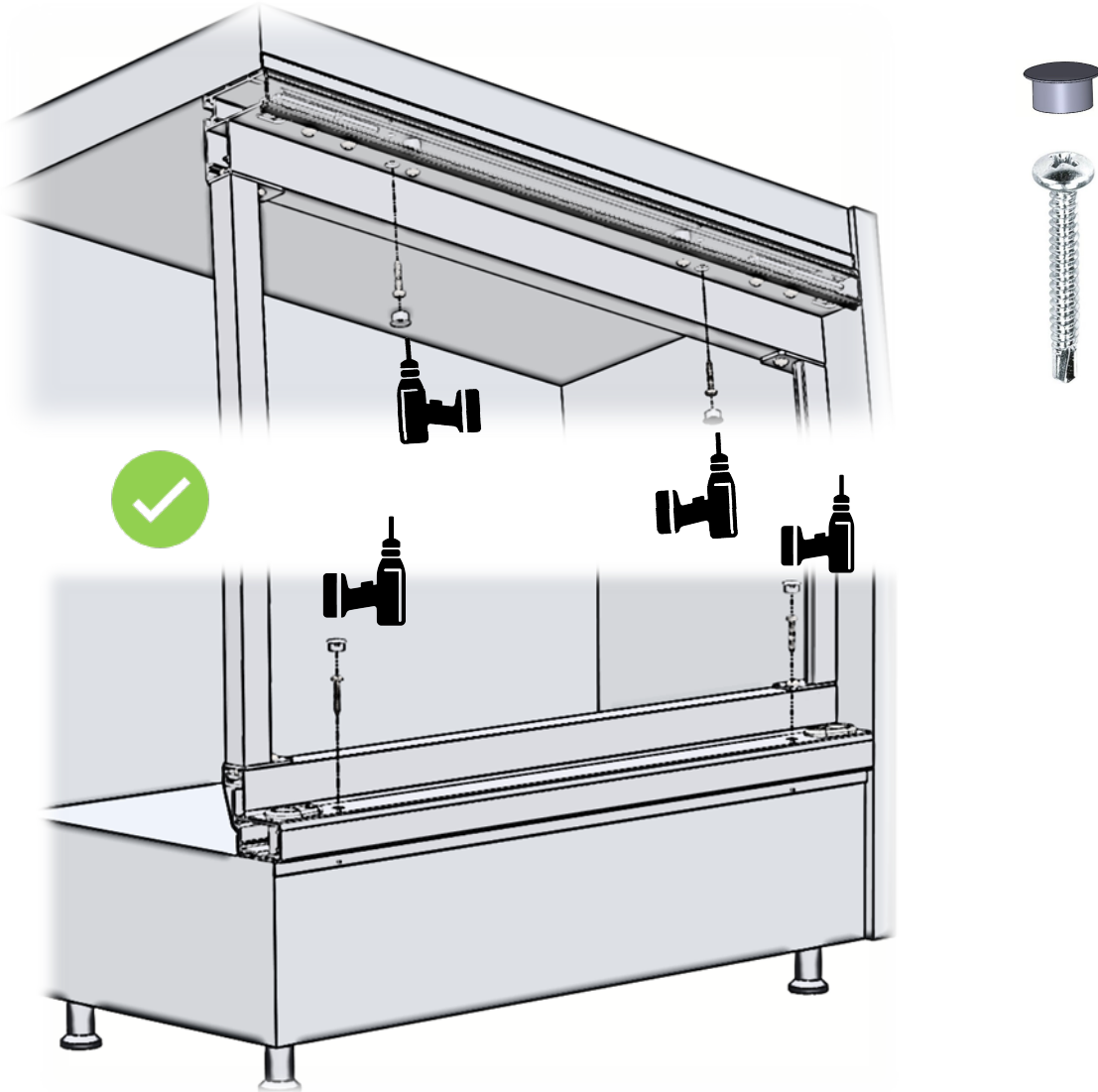

Making the frame assembly

Screw the frame to the cooler as shown. Fit the plastic plugs of the screw holes.

Making the frame ready for door assembly

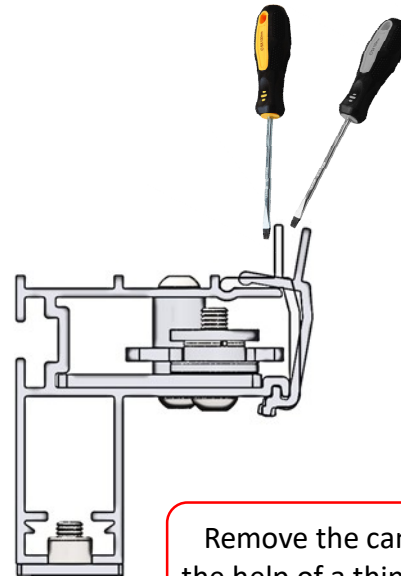
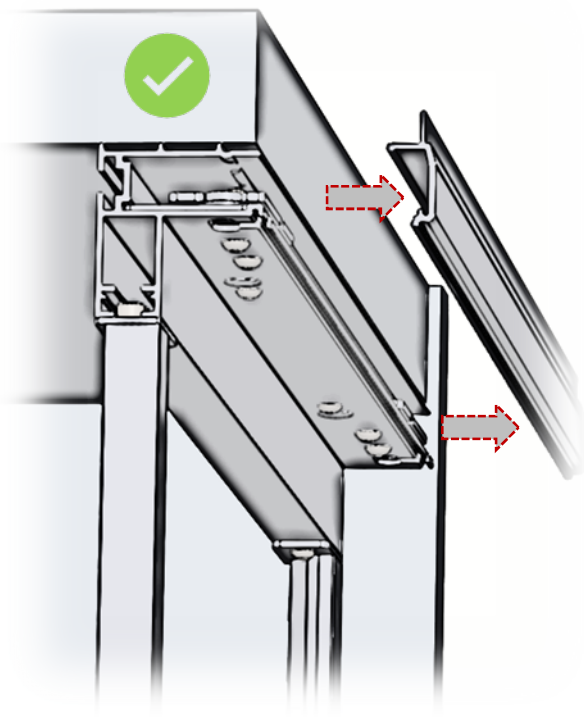

Remove the canopy cover with the help of a thin flat blade screwdriver as shown in the image.

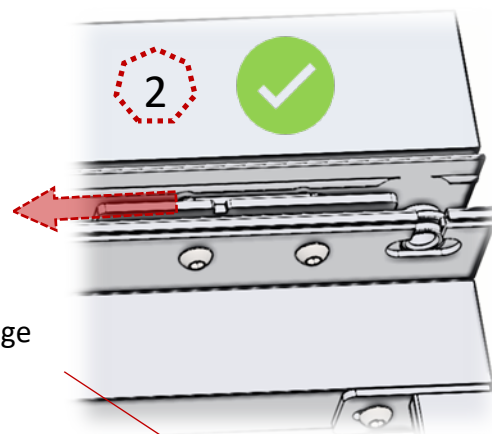
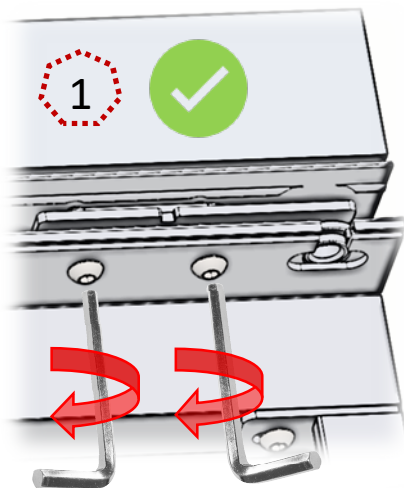

plastic hinge bush

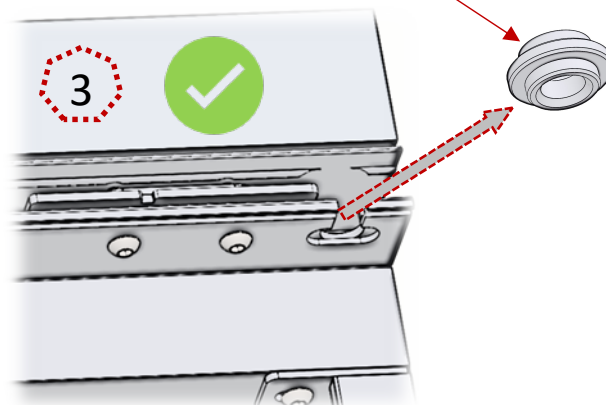

Loosen the miter adjustment mechanism support bolts as shown in the figure, slide the paw lock to the left and remove the plastic hinge bush!

Installing the door

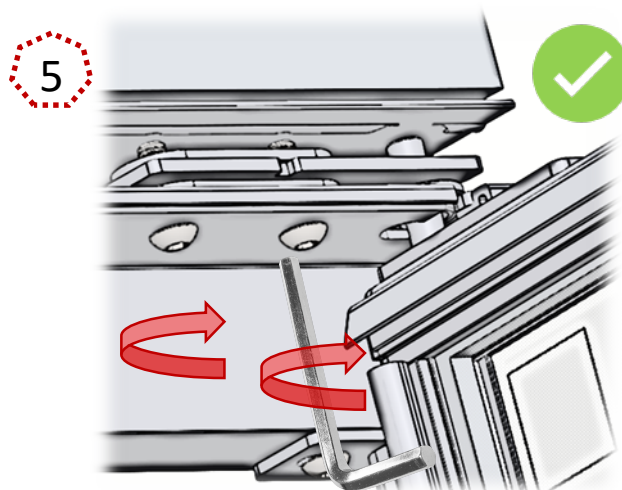
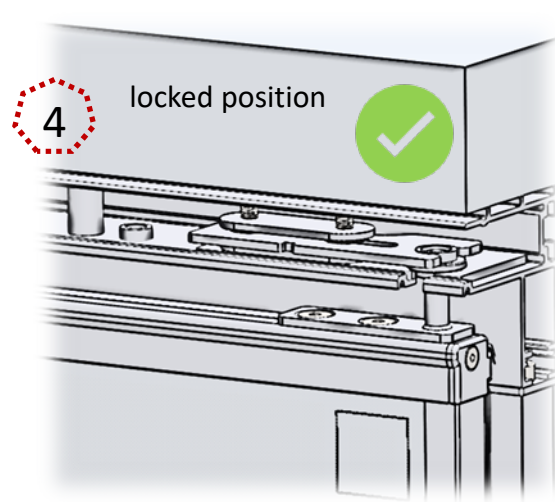
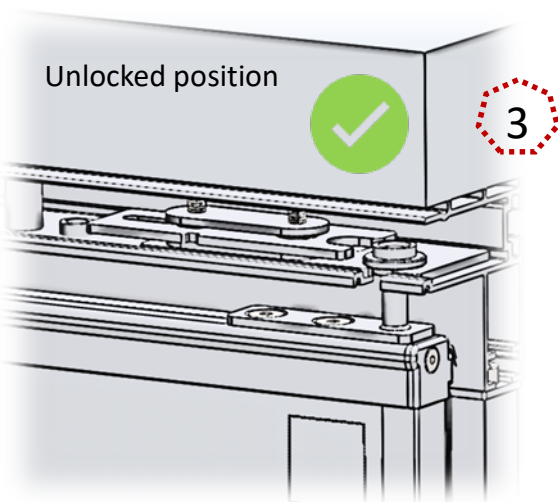
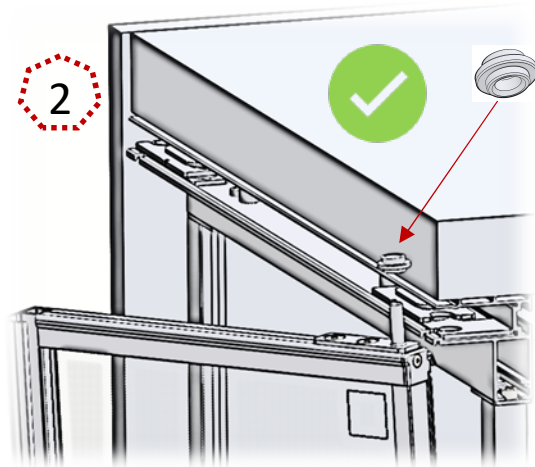
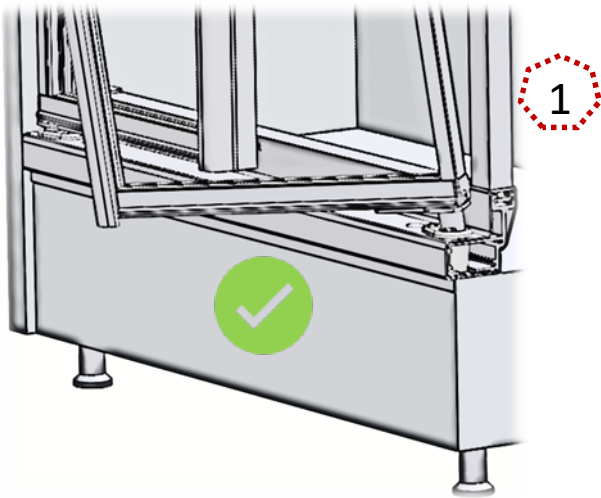

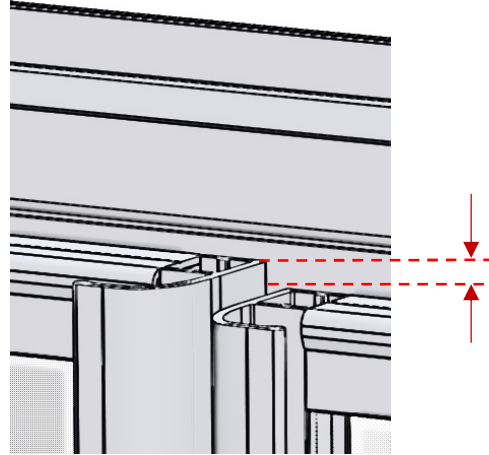
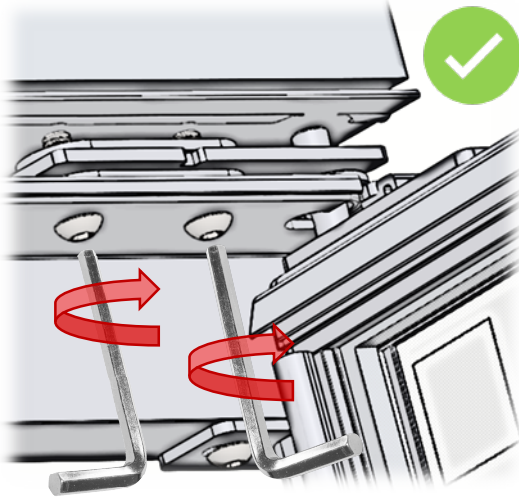
Setting the door miter

Shifted position to the left

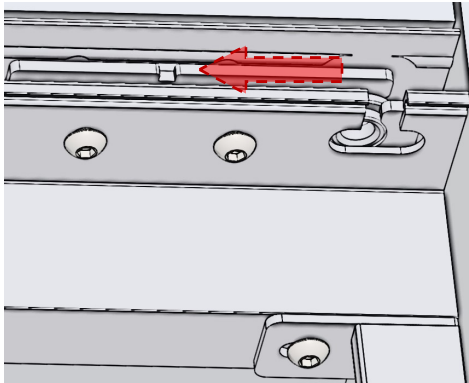

Neutral position

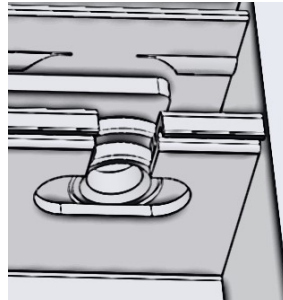

Shifted position to the left

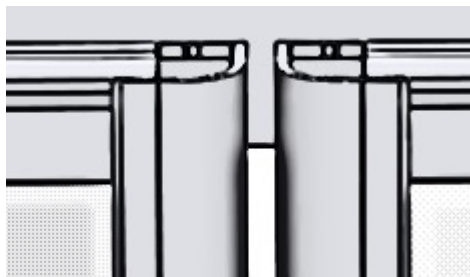
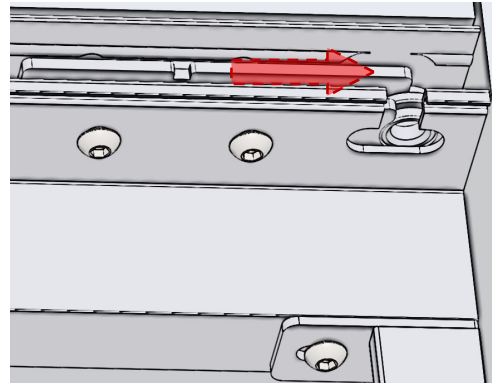

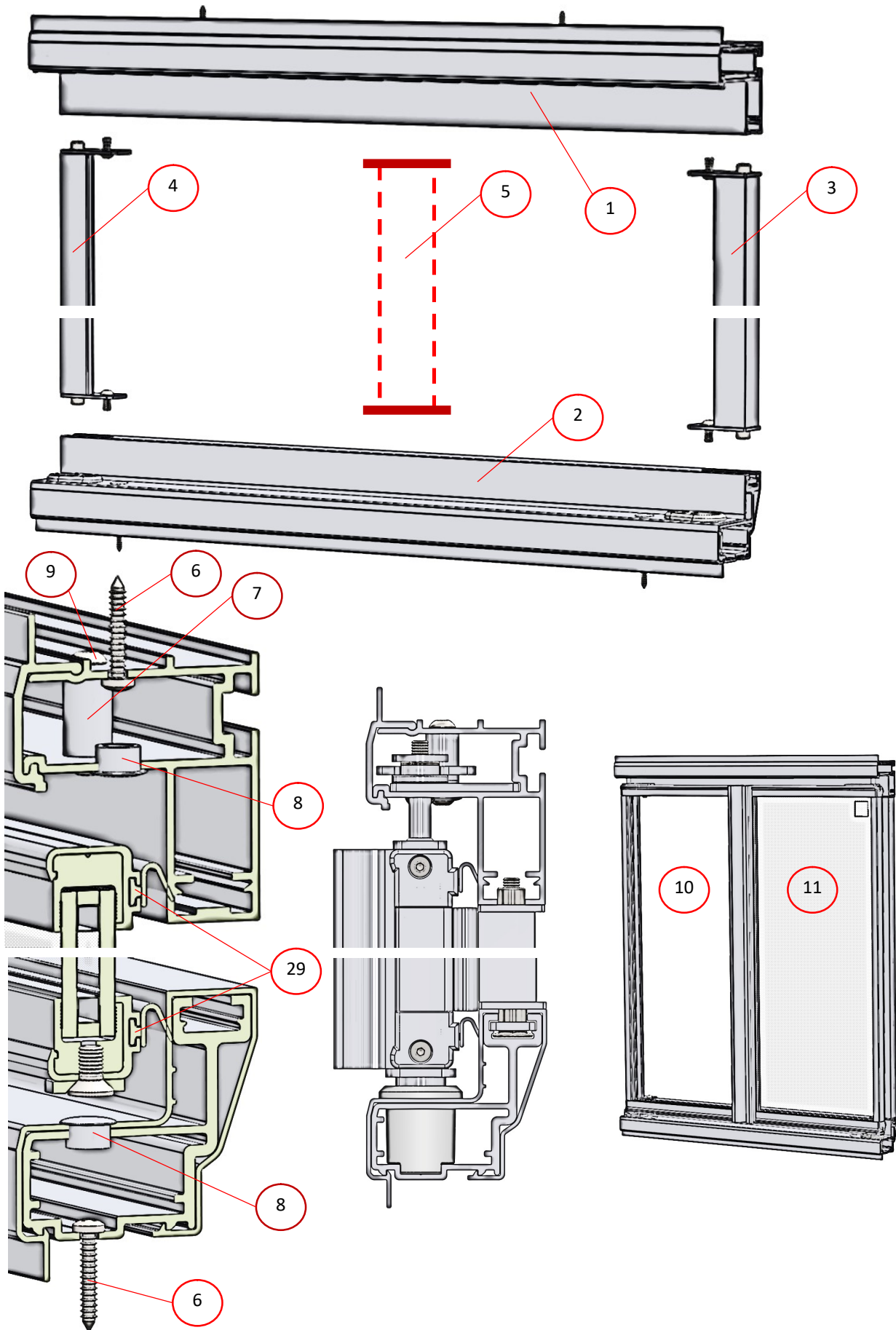
Frame structure

Spare part-exploded drawing

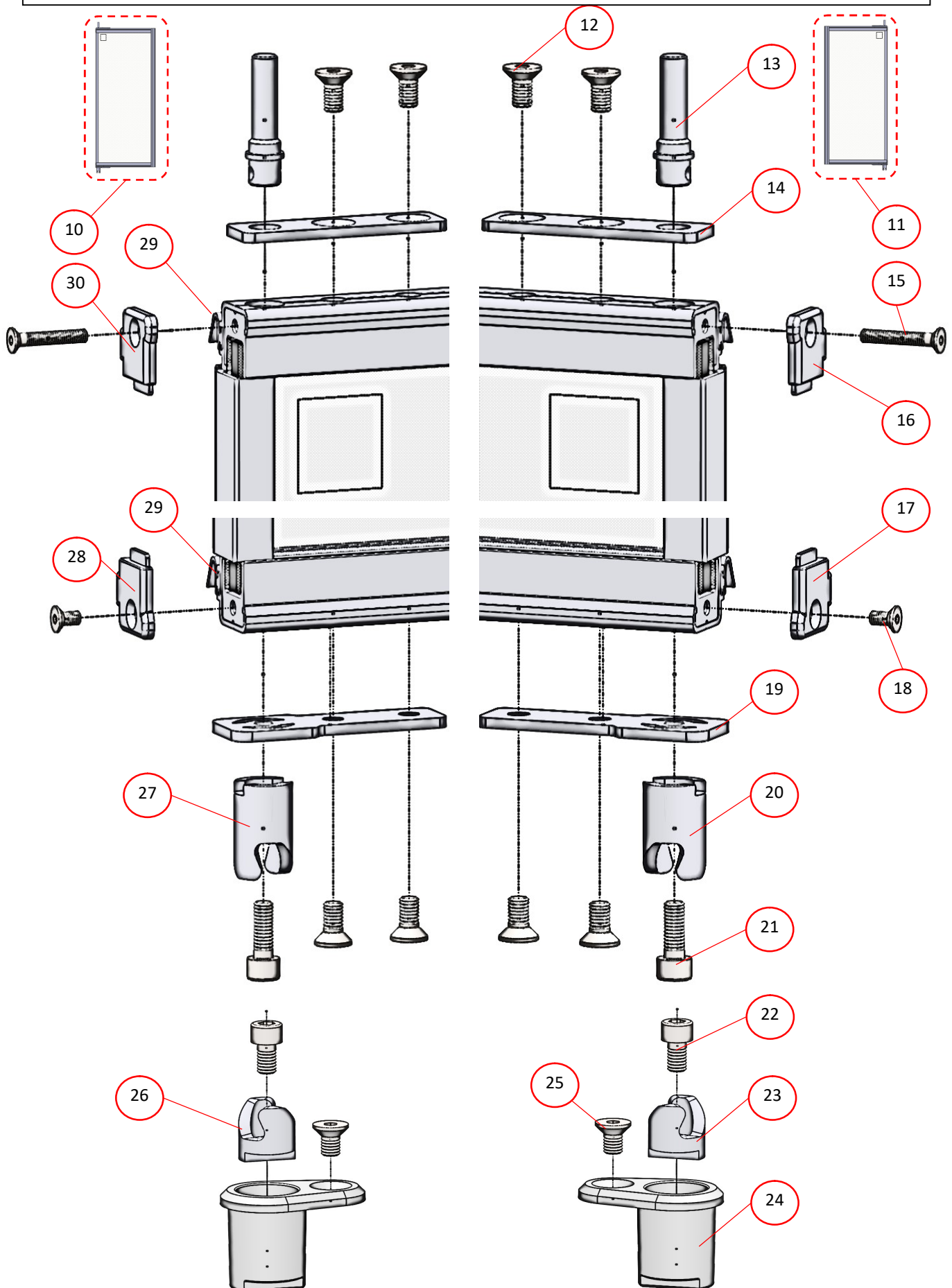

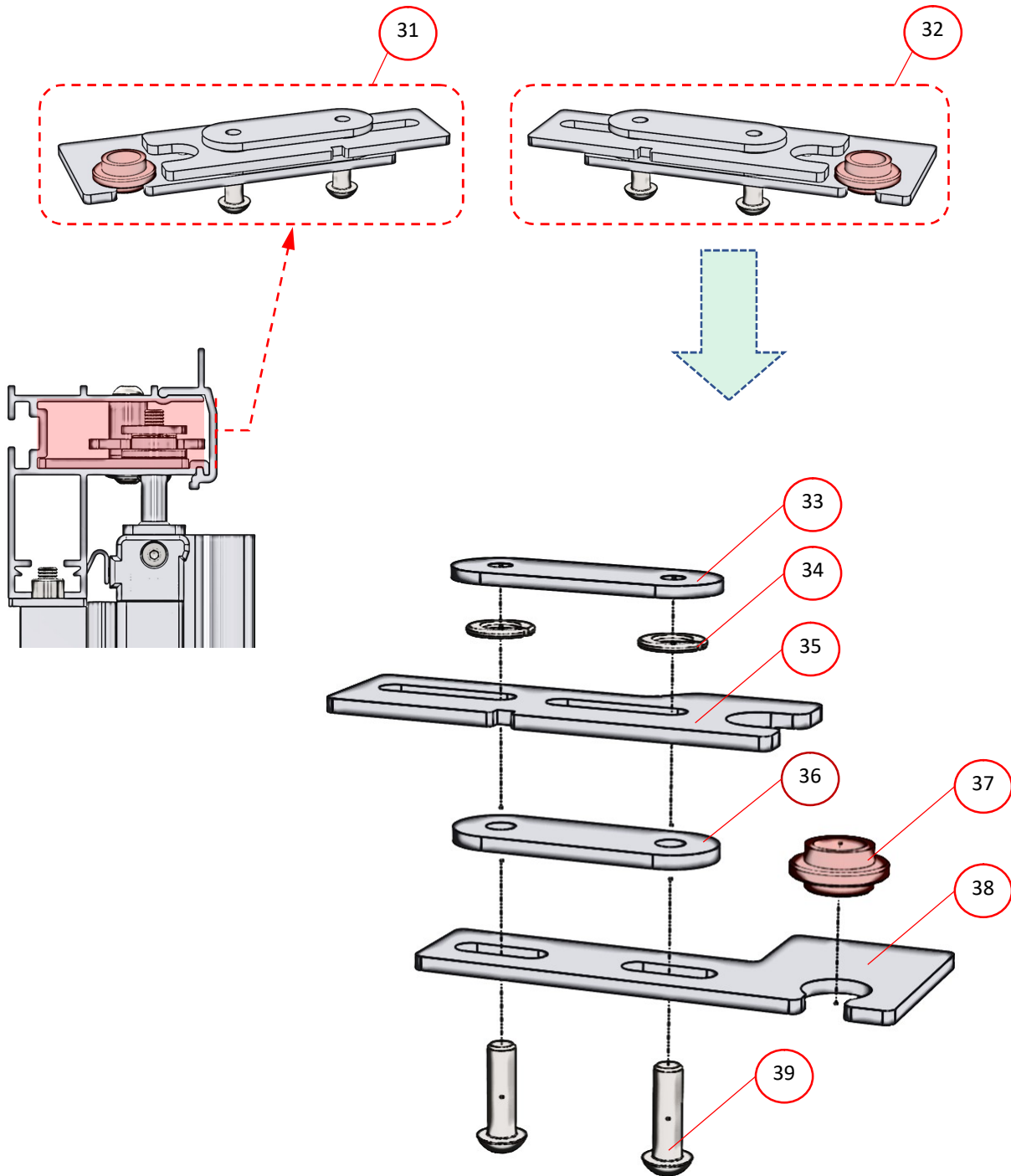
Door miter adjustment mechanism

11. Teknik Detaylar

TECHNICAL DATA SHEET

Climate Class	3 (25 °C 60 %RH)
M Pack Class	M1
Case Temp (°C)	-1 / +2
Supply	220 V 50 Hz

Technical Details

	1250	1875	2500
Compressor	EMBRACO NT 6226 GK	EMBRACO NJ 9238 GK	2 X EMBRACO NT 6226 GK
Refrigerant	R449	R449	R449
Min. Current Fuse	16 A.	16 A.	25 A.
Actually run power W	1069	1617	2409

ENERGY EFFICIENCY VALUES

Annual energy consumption	10147,0 kWh/a	19102,5 kWh/a	14089,0 kWh/a
EEL	92,51	97,46	84,2
Energy Efficiency Class	G	G	G

Expansion Valves

	1250	1875	2500
Thermostatic Valve	TES 2	TES 2	TES 2
Orifice	01	02	2 X 01

Evaporators

	1250	1875	2500
Cod			
Evaporators	44 38 1/2" 4 DX 07 980 7,5 MM 02 RR	44 38 1/2" 4 DX 07 1605 7,5 MM 02 RR	44 38 1/2" 4 DX 07 2130 7,5 MM 02x2 RR-LL

Condanser

	1250	1875	2500
Cod			
Condansers	25 22 3 CD 22 520 4,2 RR Horizontal	25 22 3 CD 22 750 4,2 RR Horizontal	25 22 3 CD 22 520 4,2 RR Horizontal - 25 22 3CD 22 520 4,2 LL Hor.

Electrical Items

Fan

		1250	1875	2500
Evaporator	Cod			
	AKSA AKS 688-20 n°x W	2 x 32	3 x 32	4 x 32
	Cod	20840103	20840103	20840103
	Blade	28° A Ø200 mm		

Condenser	Cod			
	AKSA AKS 688-20	n°x W	2 x 32	2 x 32 4 x 32
	Cod		20840103	20840103 20840103
	Blade		28" A	Ø200 mm

Lighting

			1250	1875	2500
LED	Cod		22340218	22340218	22340219
	Alto Pure 4000 K	n°x W	1 x 16	2 x 16	2 x 18
	Cod		22340220	22340220	22340221
	Alto Pure 3000 K	n°x W	1 x 15	2 x 15	2 x 18

Air Flow Info

Air speed on honeycomb : 1,1 m/s at ambient conditions

Controls

Thermostat				
Set Point °C	Differential	Sensor	Melt interval Hour	Melt period Minute
-0,5	2	Air Off	0	0

Alarms	
Alarm Set Point °C	Alarm Delay Time Minute
+15	0

Defrosting					
Dripping time Minute	Fan During Defrost	Type	n°/24	End defrost temperature °C	Maximum defrost duration Minute
0	ON	Off cycle	8	6	45

TECHNICAL DOCUMENTATION DATA SHEET		CHAPTER REVISION STATUS		
PRODUCT		ORD.	DATE	CHANGE ORDER
DATE of 1st ISSUE	27.01.2021	A		
ORDER	A.Çalışkan	B		
		C		

TECHNICAL DATA SHEET

Climate Class	3 (25 °C 60 %RH)
M Pack Class	M1
Case Temp (°C)	-1 / +2
Supply	220 V 50 Hz

Technical Details

	1250	1875	2500
Compressor	EMBRACO NEU 6212 GK	EMBRACO NT 6220 GK	EMBRACO NT 6226 GK
Refrigerant	R449A	R449A	R449A
Min. Current Fuse	16 A.	16 A.	16 A.
Actually run power W	586	1005	1166

ENERGY EFFICIENCY VALUES

Annual energy consumption	4816,0 kWh/a	5650,0 kWh/a	7687,0 kWh/a
EEl	50,72	38,64	45,54
Energy Efficiency Class	E	D	D

Expansion Valves

	1250	1875	2500
Thermostatic Valve	TES 2	TES 2	TES 2
Orifice	01	01	01

Evaporators

	1250	1875	2500
Cod			
Evaporators	44 38 1/2" 4 DX 04 980 7,5 MM 02 RR	44 38 1/2" 4 DX 04 1605 7,5 MM 02 RR	44 38 1/2" 4 DX 04 2230 7,5 MM 02 RR

Condanser

	1250	1875	2500
Cod			
Condansers	25 22 3 CD 14 340 4,2 RR YATIK Horizontal	25 22 3 CD 14 520 4,2 RR Horizontal	25 22 3 CD 22 520 4,2 RR Horizontal

Electrical Items

Fan

	1250	1875	2500
Cod			
AKSA AKS 688-20 n°x W	1 x 32	2 x 32	2 x 32
Cod	20840103	20840103	20840103
Blade		28° A	Ø200 mm

Condenser	Cod			
	AKSA AKS 688-20	n°x W	1 x 32	2 x 32
	Cod		20840103	20840103
	Blade		28° A	Ø200 mm

Lighting

LED			1250	1875	2500
	Cod		22340218	22340218	22340219
	Alto Pure 4000 K	n°x W	1 x 16	2 x 16	2 x 18
	Cod		22340220	22340220	22340221
	Alto Pure 3000 K	n°x W	1 x 15	2 x 15	2 x 18

Air Flow Info

Air speed on honeycomb : 0,9 m/s at ambient conditions

Controls

Thermostat				
Set Point °C	Differential	Sensor	Melt interval Hour	Melt period Minute
-0,5	2	Air Off	0	0

Alarms	
Alarm Set Point °C	Alarm Delay Time Minute
+15	0

Defrosting					
Dripping time Minute	Fan During Defrost	Type	n°/24	End defrost temperature °C	Maximum defrost duration Minute
0	ON	Off cycle	8	6	45

TECHNICAL DOCUMENTATION DATA SHEET		CHAPTER REVISION STATUS		
PRODUCT		ORD.	DATE	CHANGE ORDER
DATE of 1st ISSUE	27.01.2021	A		
ORDER	A.Çalışkan	B		
		C		

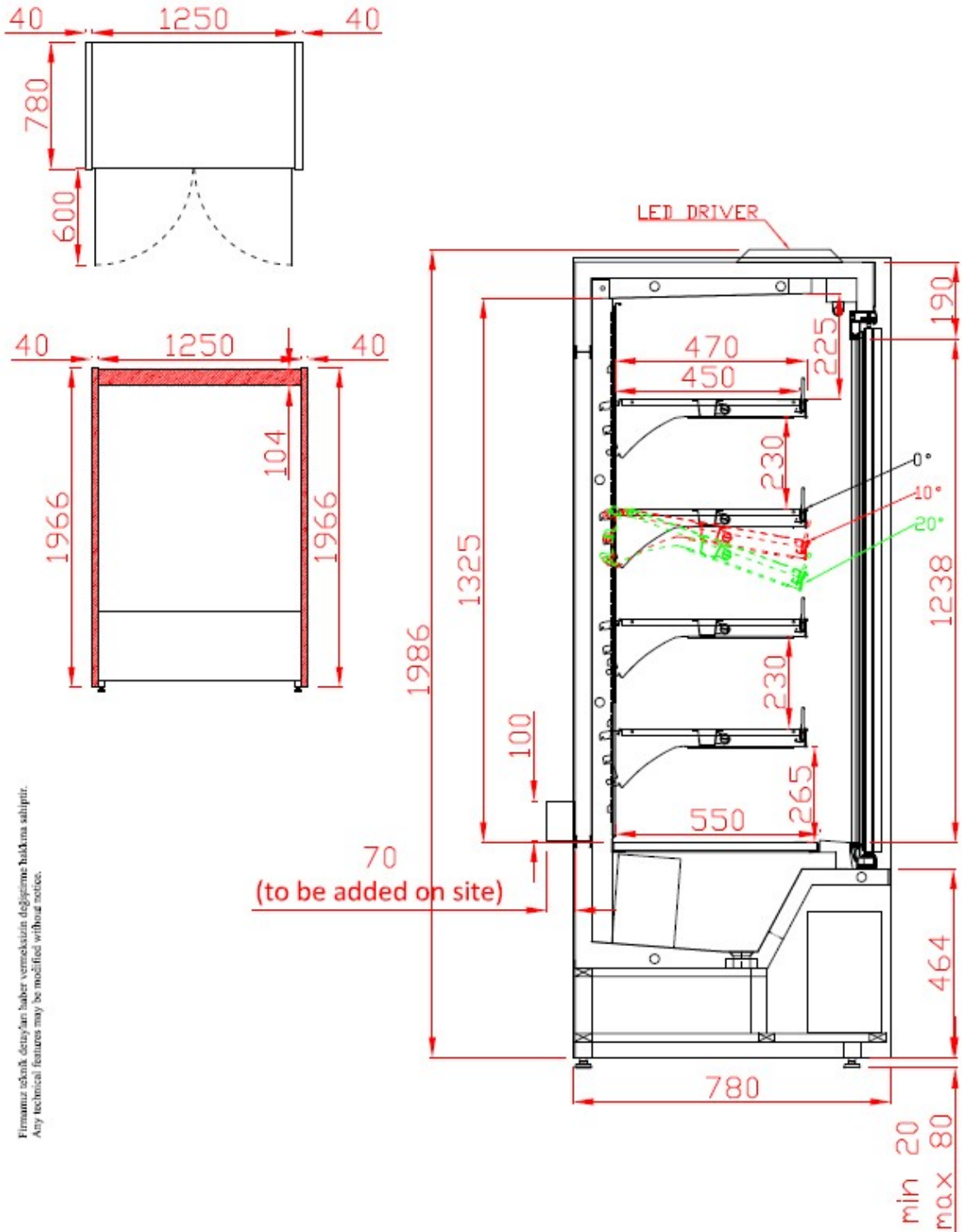

Firmamız teknik çizimlerde değişiklik yapma hakkına sahiptir.
Any technical features may be modified without notice.

01 / 2021

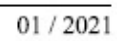

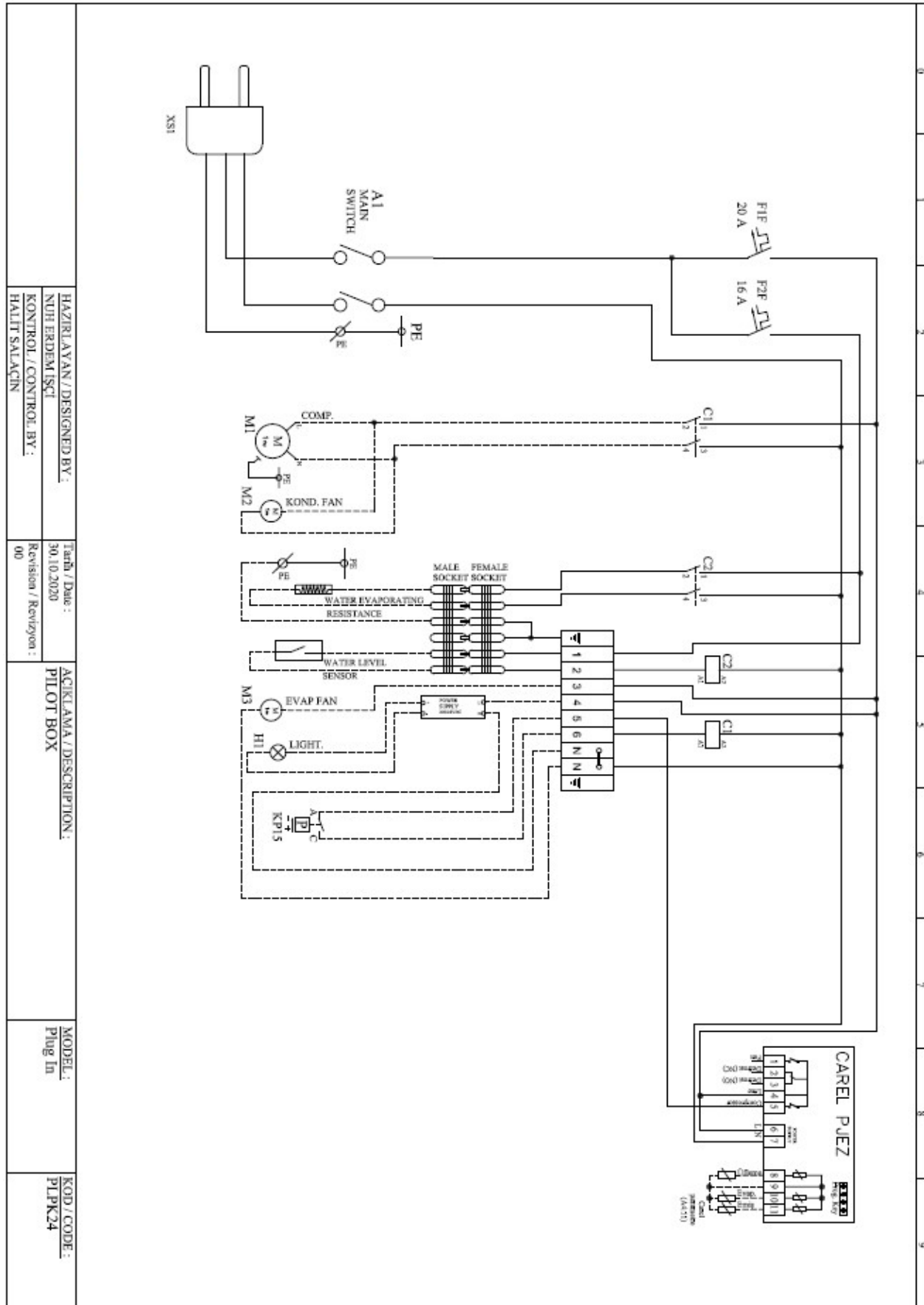

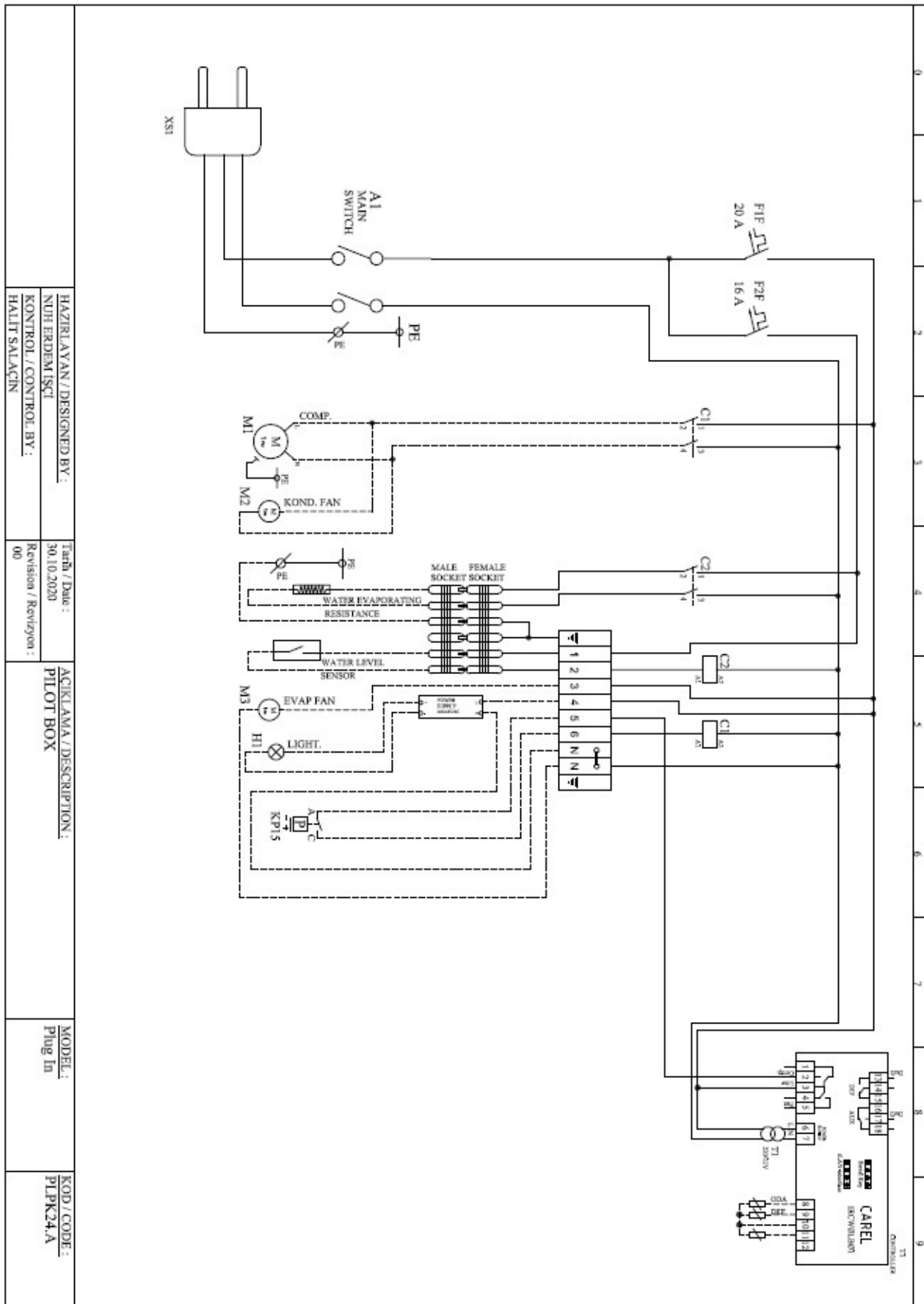

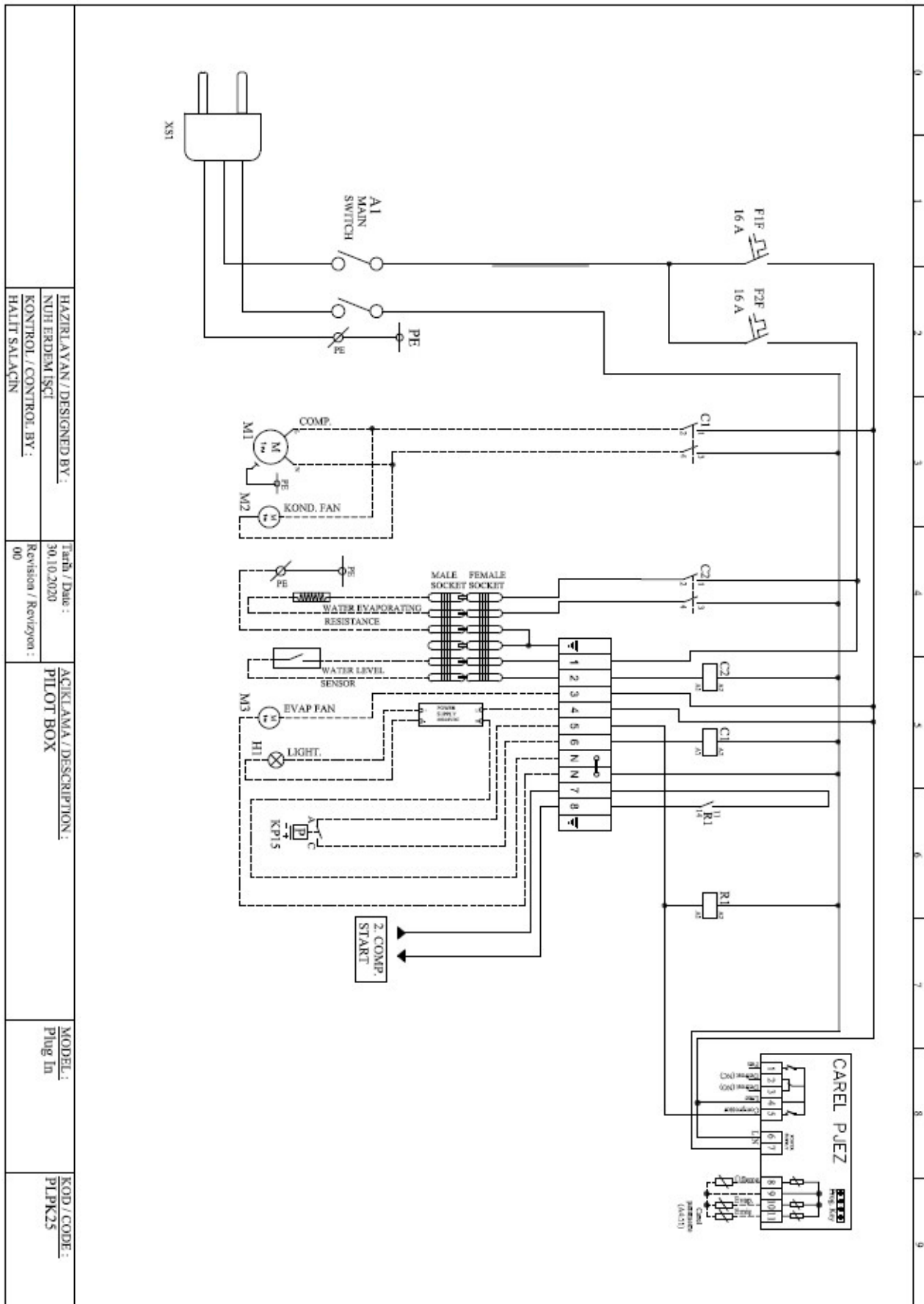

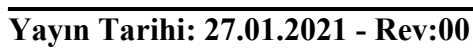

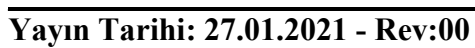

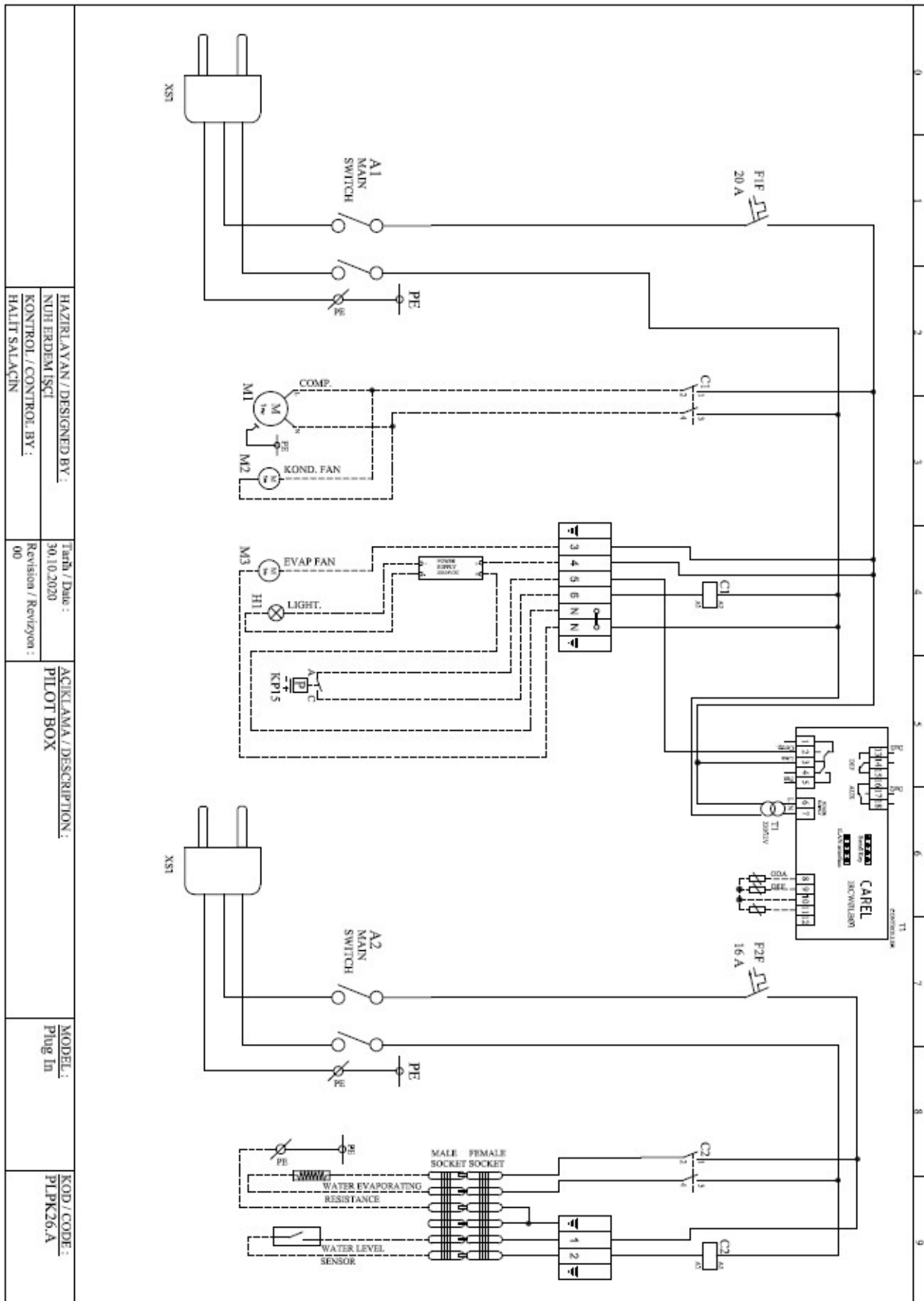

SAFRANBOLU SPARE PARTS LIST

POS.	CODE	DESCRIPTION	GLASS DOOR (GD)			OPEN FRONT (OF)			UNIT
			1250	1875	2500	1250	1875	2500	
1	497202021	EVAPORATOR GD CASE 1250	1	-	-	-	-	-	PCS
	497203021	EVAPORATOR GD CASE 1875	-	1	-	-	-	-	PCS
	497204021	EVAPORATOR GD CASE 2500	-	-	1	-	-	-	PCS
	497202022	EVAPORATOR OF CASE 1250	-	-	-	1	-	-	PCS
	497203022	EVAPORATOR OF CASE 1875	-	-	-	-	1	-	PCS
	497204022	EVAPORATOR OF CASE 2500	-	-	-	-	-	1	PCS
2	20301025	TE2 THERM.EXP.VALF (R448A/R449A)DANFOSS	1	1	1	1	1	2	PCS
	20301006	ORIFICE DANFOSS NO:01 - 068-2021	1	1	1	1	-	2	PCS
	20301007	ORIFICE DANFOSS NO:02 - 068-2022	-	-	-	-	1	-	PCS
	21406010	SIGHT GLASS 3/8"	1	1	1	1	1	2	PCS
	20203019	DRAYER 3/8" DANFOSS DCL 053S	1	1	1	1	1	2	PCS
	20403001	PRESSURE SWITCH DANFOSS KP15	1	1	1	1	1	2	PCS
3	498000005	CONDENSER GD CASE 1250	1	-	-	-	-	-	PCS
	498000006	CONDENSER GD CASE 1875	-	1	-	-	-	-	PCS
	498000007	CONDENSER GD CASE 2500/OF CASE 1250/OF CASE 2500	-	-	1	1	-	2	PCS
	498000008	CONDENSER OF CASE 1875	-	-	-	-	1	-	PCS
4	21102004	CONDENSER FAN MOTOR	1	2	2	2	2	4	PCS
5	21105008	CONDENSER FAN BLADE D:200 A28°	1	2	2	2	2	4	PCS
6	21102004	EVAPORATOR FAN MOTOR	1	2	2	2	3	4	PCS
7	21105008	EVAPORATOR FAN BLADE D:200 A28°	1	2	2	2	3	4	PCS
8	21106009	FAN CONNECTION PLASTIC PART	8	16	16	16	20	32	PCS
9	302302059	EVAPORATOR FAN BUFFLE GD CASE 1250	1	-	-	-	-	-	PCS
	302303060	EVAPORATOR FAN BUFFLE GD CASE 1875	-	1	-	-	-	-	PCS
	302304060	EVAPORATOR FAN BUFFLE GD CASE 2500	-	-	1	-	-	-	PCS
	302302060	EVAPORATOR FAN BUFFLE OF CASE 1250	-	-	-	1	-	-	PCS
	302303061	EVAPORATOR FAN BUFFLE OF CASE 1875	-	-	-	-	1	-	PCS
	302304062	EVAPORATOR FAN BUFFLE OF CASE 2500	-	-	-	-	-	1	PCS
10	402300270	HOT GAS DISCHARGE COIL	-	-	-	1	1	1	PCS
11	23808449	SS DRIP TRAY OF CASE HOT GAS DISCHARGE COIL	-	-	-	1	1	1	PCS
12	23808442	SS DRIP TRAY GD CASE	1	1	1	-	-	-	PCS
	23808443	SS DRIP TRAY OF CASE	-	-	-	1	1	1	PCS
13	23808444	SS DRIP TRAY COVER	1	1	1	1	1	1	PCS
14	22703008	DRIP TRAY HEATER 1100 W	1	1	1	1	1	1	PCS
15	29999266	DRIP TRAY LEVEL SENSOR	1	1	1	1	1	1	PCS
16	302300084	DRIP TRAY CONNECTION SHEET FRONT RH	1	1	1	1	1	1	PCS
17	302300089	DRIP TRAY CONNECTION SHEET FRONT LH						1	PCS
18	302300085	DRIP TRAY CONNECTION SHEET FOR OF CASE				1	1	2	PCS
	302300088	DRIP TRAY CONNECTION SHEET FOR GD CASE	1	1	1				PCS

19	20101052	EMBRACO NEU 6212 GK	1	-	-	-	-	-	PCS
	20102101	EMBRACO NT 6220 GK	-	1	-	-	-	-	PCS
	20101038	EMBRACO NT 6226 GK	-	-	1	1	-	2	PCS
	20101048	EMBRACO NJ 9238 GK	-	-	-	-	1	-	PCS
20	20503030	CONTROLLER CAREL PJEZC00000	1	1	1	1	1	1	PCS
21	20502008	CONTROLLER SENSOR NTC030HP00 3MT	2	2	2	2	2	2	PCS
22	22601020	LED DRIVER 150 W - 24V	1	1	1	1	1	1	PCS
23	302300018	ELECTRICAL BOX STANDART	1	1	1	1	-	-	PCS
	302300075	ELECTRICAL BOX OF CASE 1875	-	-	-	-	1	-	PCS
	302300076	ELECTRICAL BOX OF CASE 2500	-	-	-	-	-	1	PCS
24	402302273	LOWER DECOR 1250 CASE	1	-	-	1	-	1	PCS
	402303273	LOWER DECOR 1875 CASE	-	1	-	-	1	-	PCS
	402304283	LOWER DECOR 2500 GD CASE	-	-	1	-	-	-	PCS
	402302283	LOWER DECOR LEFT 1250 FOR 2500 OF CASE	-	-	-	-	-	1	PCS
25	402302269	LOWER DECOR TOP CHANNEL PROFILE 1250	1	-	-	1	-	-	PCS
	402303269	LOWER DECOR TOP CHANNEL PROFILE 1875	-	1	-	-	1	-	PCS
	402304269	LOWER DECOR TOP CHANNEL PROFILE 2500	-	-	1	-	-	1	PCS
26	402302270	LOWER DECOR BOTTOM CHANNEL PROFILE 1250	1	-	-	1	-	-	PCS
	402303270	LOWER DECOR BOTTOM CHANNEL PROFILE 1875	-	1	-	-	1	-	PCS
	402304270	LOWER DECOR BOTTOM CHANNEL PROFILE 2500	-	-	1	-	-	1	PCS
27	23205060	FRONT GLASS 1250	-	-	-	1	-	-	PCS
	23205035	FRONT GLASS 1875	-	-	-	-	1	-	PCS
	23205036	FRONT GLASS 2500	-	-	-	-	-	1	PCS
28	24004140	GLASS DOOR FRAME 1250	1	-	-	-	-	-	PCS
	24004141	GLASS DOOR FRAME 1875	-	1	-	-	-	-	PCS
	24004142	GLASS DOOR FRAME 2500	-	-	1	-	-	-	PCS
29	24004143	GLASS DOOR 625 MM RH	1	1	2	-	-	-	PCS
	24004144	GLASS DOOR 625 MM LH	1	2	2	-	-	-	PCS
30	22613050	FRAME LED LIGHTING 4000 K , 1155 MM , 12 W	2	4	4	-	-	-	PCS
	22613013	CANOPY LED LIGHTING 4000K , 1200 MM , 20 W	1	-	2	1	-	2	PCS
	22613049	CANOPY LED LIGHTING 4000K , 1800 MM , 25 W	-	1	-	-	1	-	PCS
31	302302295	FRONT SS BUMBER PART GD CASE 1250	1	-	-	-	-	-	PCS
	302303295	FRONT SS BUMBER PART GD CASE 1875	-	1	-	-	-	-	PCS
	302304295	FRONT SS BUMBER PART GD CASE 2500	-	-	1	-	-	-	PCS
	302302296	FRONT SS BUMBER PART OF CASE 1250	-	-	-	1	-	-	PCS
	302303296	FRONT SS BUMBER PART OF CASE 1875	-	-	-	-	1	-	PCS
	302304296	FRONT SS BUMBER PART OF CASE 2500	-	-	-	-	-	1	PCS
32	302302256	SUCTION GRILL GD CASE 1250	1	-	-	-	-	-	PCS
	302303256	SUCTION GRILL GD CASE 1875	-	1	-	-	-	-	PCS
	302304256	SUCTION GRILL GD CASE 2500	-	-	1	-	-	-	PCS
	302302294	SUCTION GRILL OF CASE 1250	-	-	-	1	-	-	PCS
	302303294	SUCTION GRILL OF CASE 1875	-	-	-	-	1	-	PCS
	302304294	SUCTION GRILL OF CASE 2500	-	-	-	-	-	1	PCS
33	402300245	BASE DECK GD CASE	2	3	4	-	-	-	PCS
	402300246	BASE DECK OF CASE	-	-	-	2	3	4	PCS

34	402302249	BACK PANEL BOTTOM GD CASE 1250	1	-	2	-	-	-	PCS
	402301249	BACK PANEL BOTTOM GD CASE 937	-	2	-	-	-	-	PCS
	402302250	BACK PANEL BOTTOM OF CASE 1250	-	-	-	1	-	2	PCS
	402301250	BACK PANEL BOTTOM OF CASE 937	-	-	-	-	2	-	PCS
35	402302247	BACK PANEL TOP GD CASE 1250	1	-	2	-	-	-	PCS
	402301247	BACK PANEL TOP GD CASE 937	-	2	-	-	-	-	PCS
	402302248	BACK PANEL TOP OF CASE 1250	-	-	-	1	-	2	PCS
	402301248	BACK PANEL TOP OF CASE 937	-	-	-	-	2	-	PCS
36	302302057	AIR DEFLECTOR 1250	-	-	-	4	-	8	PCS
	302301057	AIR DEFLECTOR 937	-	-	-	-	8	-	PCS
37	402302241	TOP PANEL GD CASE 1250	1	-	-	-	-	-	PCS
	402303241	TOP PANEL GD CASE 1875	-	1	-	-	-	-	PCS
	402304241	TOP PANEL GD CASE 2500	-	-	1	-	-	-	PCS
	402302242	TOP PANEL OF CASE 1250	-	-	-	1	-	-	PCS
	402303242	TOP PANEL OF CASE 1875	-	-	-	-	1	-	PCS
	402304242	TOP PANEL OF CASE 2500	-	-	-	-	-	1	PCS
38	23808391	SHELF BRACKET 450 MM RH	4	8	8	-	-	-	PCS
	23808413	SHELF BRACKET 450 MM LH	4	8	8	-	-	-	PCS
	23808392	SHELF BRACKET 400 MM RH	-	-	-	4	8	8	PCS
	23808414	SHELF BRACKET 400 MM LH	-	-	-	4	8	8	PCS
39	400001241	SHELF 450 MM - 1250 MM	4	-	8	-	-	-	PCS
	400001242	SHELF 450 MM - 937 MM	-	8	-	-	-	-	PCS
	400001243	SHELF 400 MM - 1250 MM	-	-	-	4	-	8	PCS
	400001244	SHELF 400 MM - 937 MM	-	-	-	-	8	-	PCS
40	400003206	SHELF TRAVERS 1250 MM	4	-	8	4	-	8	PCS
	400003207	SHELF TRAVERS 937 MM	-	8	-	-	8	-	PCS
41	10401040	TICKET STRIP 1250 MM	4	-	8	4	-	8	PCS
	10401032	TICKET STRIP 937 MM	-	8	-	-	8	-	PCS
42	23202035	PRODUCT STOPPER GLASS 1250 MM	4	-	8	4	-	8	PCS
	23206057	PRODUCT STOPPER GLASS 937 MM	-	8	-	-	8	-	PCS
43	400002237	HONEYCOMB HOLDER SHEET 1250	-	-	-	1	-	2	PCS
	400001237	HONEYCOMB HOLDER SHEET 937	-	-	-	-	2	-	PCS
44	21403004	HONEYCOMB 1250 MM (D:6 MM H:25 MM)	-	-	-	1	2	2	PCS
45	402302238	LIGHTING SHEET GD CASE 1250	1	-	-	-	-	-	PCS
	402303238	LIGHTING SHEET GD CASE 1875	-	1	-	-	-	-	PCS
	402304238	LIGHTING SHEET GD CASE 2500	-	-	1	-	-	-	PCS
	402302239	LIGHTING SHEET OF CASE 1250	-	-	-	1	-	-	PCS
	402303239	LIGHTING SHEET OF CASE 1875	-	-	-	-	1	-	PCS
	402304239	LIGHTING SHEET OF CASE 2500	-	-	-	-	-	1	PCS
46	21504002	NIGHT BLIND 1250	-	-	-	1	-	2	PCS
	21504001	NIGHT BLIND 937	-	-	-	-	2	-	PCS

47	402302286	UPPER DECOR GD CASE 1250	1	-	-	-	-	-	PCS
	402303286	UPPER DECOR GD CASE 1875	-	1	-	-	-	-	PCS
	402304286	UPPER DECOR GD CASE 2500	-	-	1	-	-	-	PCS
	402302287	UPPER DECOR OF CASE 1250	-	-	-	1	-	-	PCS
	402303287	UPPER DECOR OF CASE 1875	-	-	-	-	1	-	PCS
	402304287	UPPER DECOR OF CASE 2500	-	-	-	-	-	1	PCS
48	24101059	CASE LEG M16	4	8	8	4	8	8	PCS
49	402300940	ENDWALL SOLID RH	1	1	1	-	-	-	PCS
	402300941	ENDWALL SOLID LH	1	1	1	-	-	-	PCS
	402300942	ENDWALL MİRRORED RH	-	-	-	1	1	1	PCS
	402300943	ENDWALL MİRRORED LH	-	-	-	1	1	1	PCS

